

Heart of Bethesda



- 20,253 SF
- Entire 7th floor
- Available immediately through October 31, 2017
- Offered fully furnished with new build out
- Rate is Negotiable

7600 WISCONSIN AVENUE | BETHESDA MARYLAND

SEVENTH FLOOR — FLOORPLAN

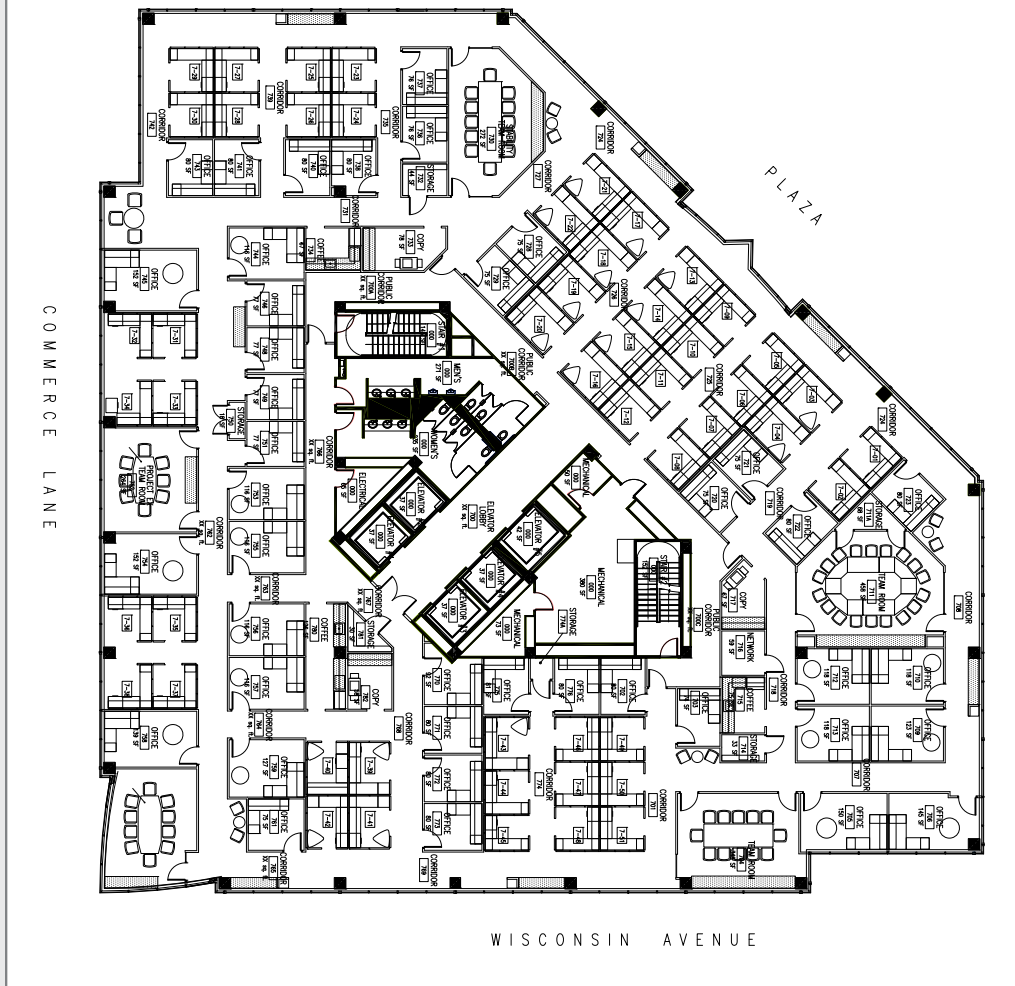

FOR MORE INFORMATION CONTACT

BOB NEUMAN :: 202.682.8743 :: BNEUMAN@JMZELL.COM

BILL BREWER :: 202.682.8742 :: WBREWER@JMZELL.COM

2900 K STREET :: SUITE 525 :: WASHINGTON, DC 20007 :: 202.682.8722 :: WWW.JMZELL.COM